

Alperton regeneration update

Housing

This map shows the current and proposed developments in Alperton to provide new homes.



New residential development, Minavil House, Ealing Road

One to 11 storey building comprising of retail at ground floor, offices at first floor and 55 flats above.

Planning permission Ref10/0245.



Brent Council has identified the land adjoining the canal in Alperton as a growth area suitable for the construction of new homes to meet the UK wide demands of population growth and the shortage of housing.

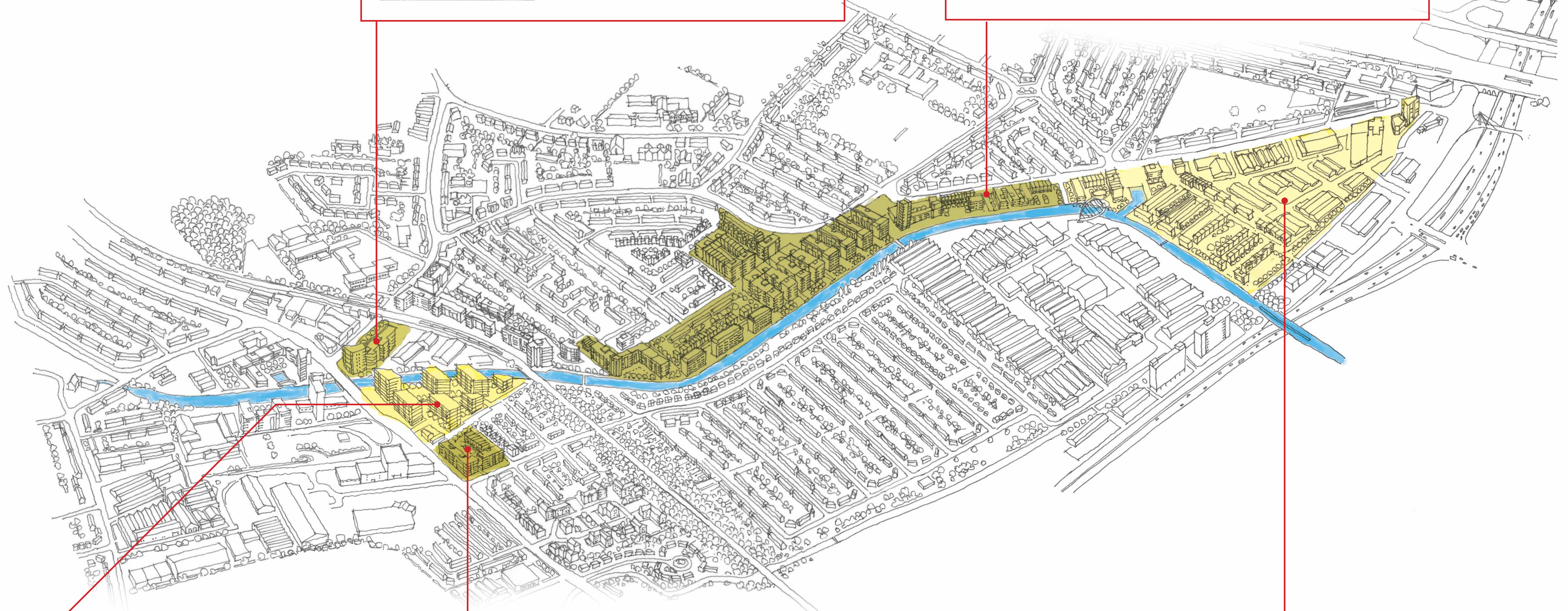

New residential development 243 Ealing Road

The scheme will deliver 441 new homes of which 111 are affordable/shared ownership. First phase due for completion in 2016.



New residential development 255 Ealing Road

This scheme was granted planning permission in October 2014 for 125 residential units, of which 38 are affordable/shared ownership.



Northfields Industrial Estate

The 'Industrial transition zone' comprises of the Northfields Industrial Estate. It will be a 'new working suburbia' combining modern light industrial units, studios and managed workspaces. The council would also like to see some new homes being delivered on this site.

Alperton regeneration update

Infrastructure delivery

The council understands the need to provide additional infrastructure to meet the needs of the growing population. This map shows current and future infrastructure projects we are working with partners to deliver.

The council is in discussion with NHS Brent CCG about GP and Dentist provisions.



Alperton Community School, Ealing Road site

The Education Funding Agency is rebuilding Alperton Community School through the Priority School Building Programme to accommodate the lower and upper school on one site. A new 9FE secondary school is due to open in September 2016 accommodating up to 1,740 students once it is complete.

The council is looking at opportunities to improve the bus service in Alperton.



New development will provide approximately 1500m² space which could be used for employment or community infrastructure.



Alperton Underground Station Refurbishment

Transport for London is refurbishing Alperton Underground Station and delivering public realm improvements to the station forecourt. This includes renovating the building, restoring the original shop fronts and de-cluttering the overall façade. Due for completion in March 2015.



Stanley Avenue

Alperton Community School is working with the council in developing proposals for a new Primary School which could also include a nursery, crèche or day centre.

Alperton regeneration update

Public realm and open space

As part of Alperton's regeneration, the council is committed to improving existing open spaces and the public realm. This map shows the projects we are delivering with our partners.



Alperton Public Realm Project

Transport for London is working with the council to make significant improvements to the public realm on Ealing Road.



There is an opportunity to use land along the canal for a Community Growing Project.



There will be funding for open space improvements. How would you like to see this funding spent?



Funding has been allocated through S106 to improve the tow path adjacent to 243 Ealing Rd.



Hazel Grove improvement project

The Canal and River Trust will be refurbishing the entrance to the canal at Hazel Grove. This will involve tree removal, landscaping and planting native shrubs.

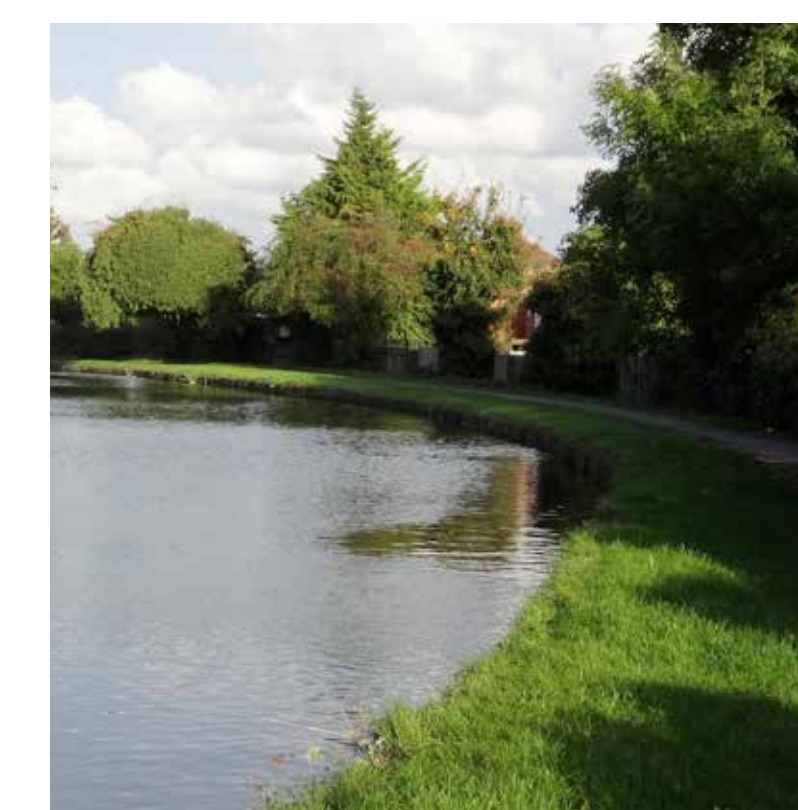

The Canal and River Trust has applied for funding for a Cycle Quiet Way on the towpath.